

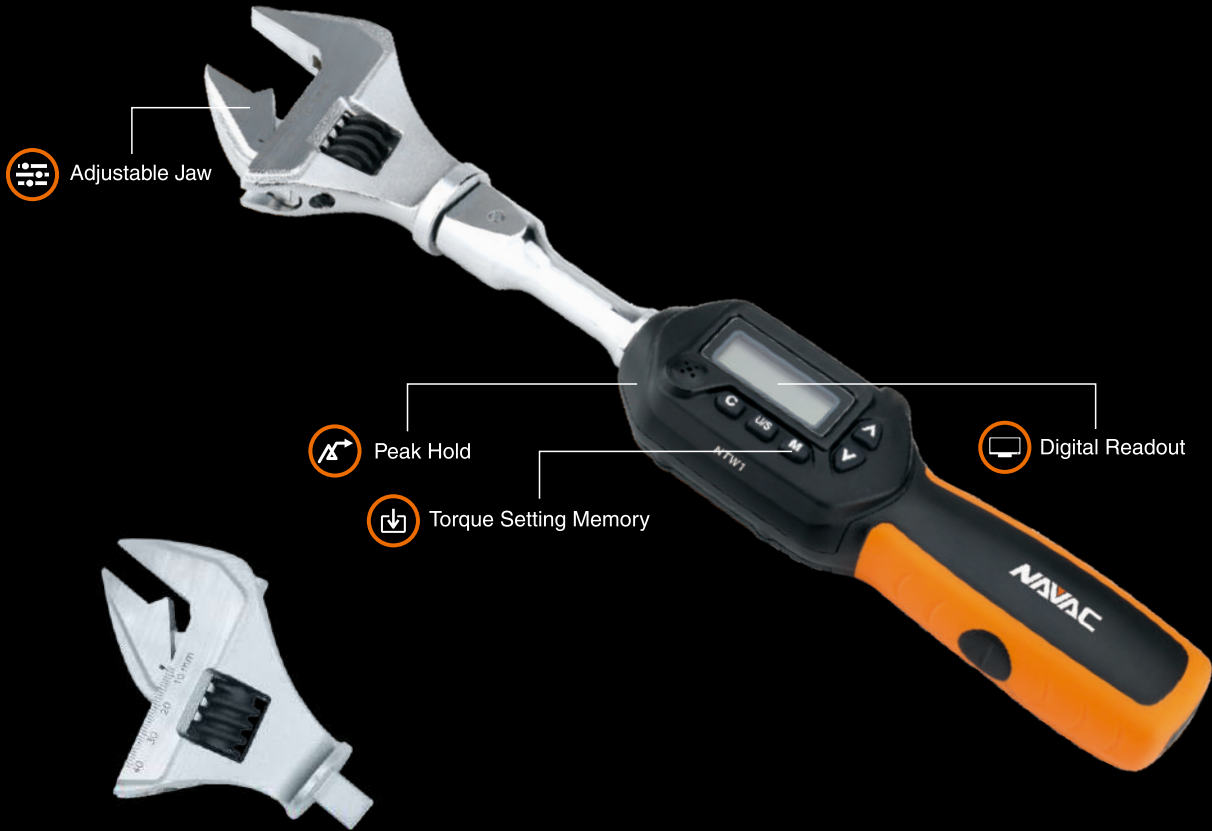

Empowering you to work smarter

# NTW1 Digital Torque Wrench



**NTWH41**

Large Wrench Head 5 - 41mm

## Digital Readout · Adjustable Jaw

- Accurate within 2%
- Dual direction (CW & CCW)
- 50 data memories & 9 pre-sets
- Peak hold
- Auto turn-off after 5 minutes inactivity
- Selectable measuring units (ft-lb, in-lb, N-m, kg-cm)
- Indicator lights and sound for target torques

Model	NTW1
Torque Measuring Range	3.1 - 62.7 ft-lb (4.2 - 85 N-m)
Jaw Size	0.2 - 1.2 inch (5 - 30 mm)
Weight	3 lbs
Accessory	Storage Case

**1-YEAR WARRANTY**